

Permit Number: 2022-010 Date Received: 9/21/22 Parcel Number: 82000990226000 Fee \$50.00

City of Vergas Application for Grade and Fill Permit

Property Description:

Lake # 56038800 Lake Name Long Parcel Number 82000990226000

Legal Description Sect 24 Twp 137 Range 041

Katzke Acres 1st Addn

Lot 3, Block 3, Addition 1st

Property: Width 100 feet, Length 230 feet

Property Owner: Jeff + Sheila Laney

Address of Project property: 92 Park View Dr.

Mailing Address: 710 3rd Ave. NE Dilworth, MN 55129

Phone: 701.306.6238

Contractors Name: Crossroads

License Number: Phone: 218 841 8618

Address 43093 Co Hwy 85 Dent, MN 56528

Note:

1. The lot lines and project area(s) must be staked before application is made.
2. If the project disturbs more than 1 acre of land, you are required to obtain a General Storm Water Permit from the Minnesota Pollution Control Agency.

On a separate paper, attached to this application, please draw a scale drawing of the project.

Please describe the project: Grade yard + driveway
Add sand blanket

Detailed Information:

Area to be cut/excavated _____ length _____ width _____ depth _____

Area to be filled/leveled _____ length _____ width _____ depth _____

Culvert(s) X yes _____ no If yes, you must indicate size and location on drawing.

Type of soils and/or fill material Black dirt, gravel, sand

Total cubic yards of earthmoving requested 122 cu yd

Signature of property owner Scott Quirk Date 9/20/22
Crossroads

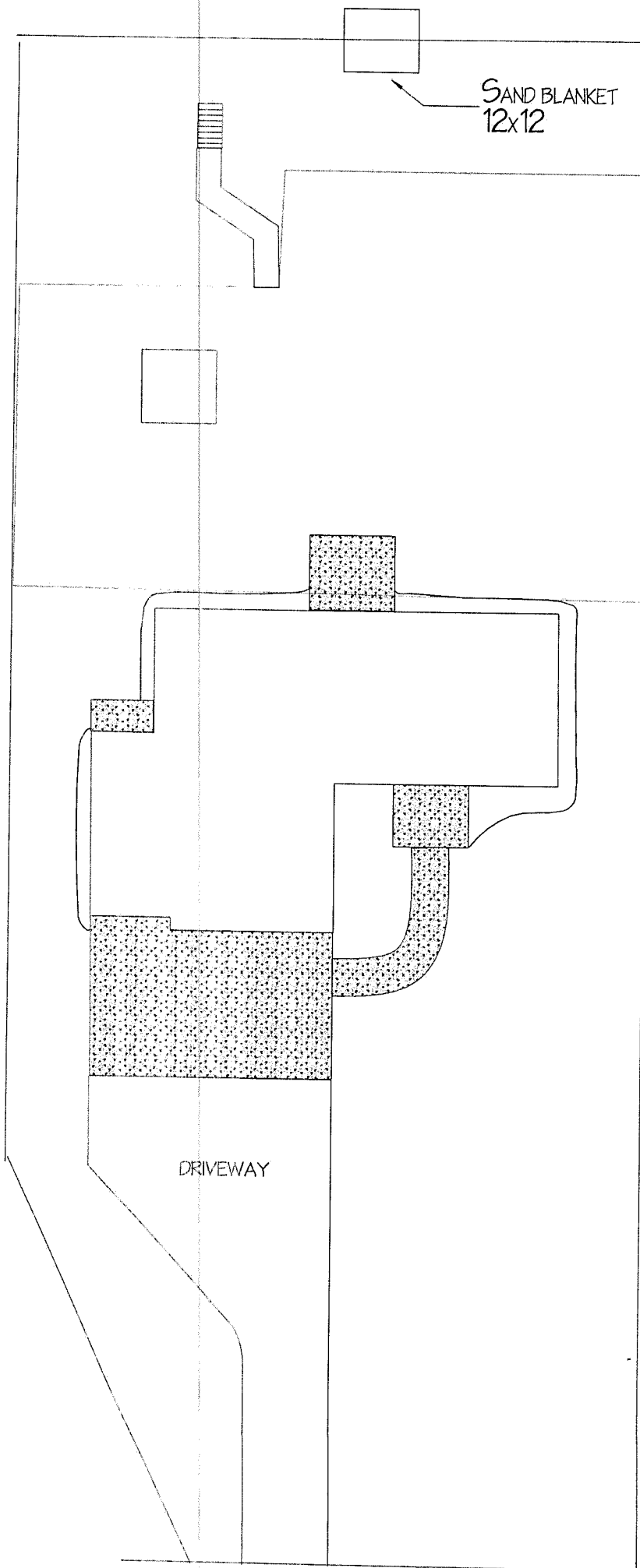

SAND BLANKET
12x12

SAND BLANKET - 8 C.Y. WASHED SAND

GRASS AREAS - 50 C.Y. BLACK DIRT
IMPORTED
40 C.Y. BLACK DIRT
ON SITE

DRIVEWAY - 24 C.Y. CLASS 5 GRAVEL

DRIVEWAY



Jeff and Sheila Laney
92 Park View Drive
Vergas, MN 56587

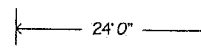

Scale: 1" = 24'

43093 County Highway 85 Dent, MN 56528
123 West Mill Street Vergas, MN 56587 218-342-3918